



# INNOVATIVE GROWERS EQUIPMENT INC.

HYDROFARM COMMERCIAL  
DIVISION

## PLANT SUPPORT SYSTEM ASSEMBLY INSTRUCTIONS

Complete Instructional Guide

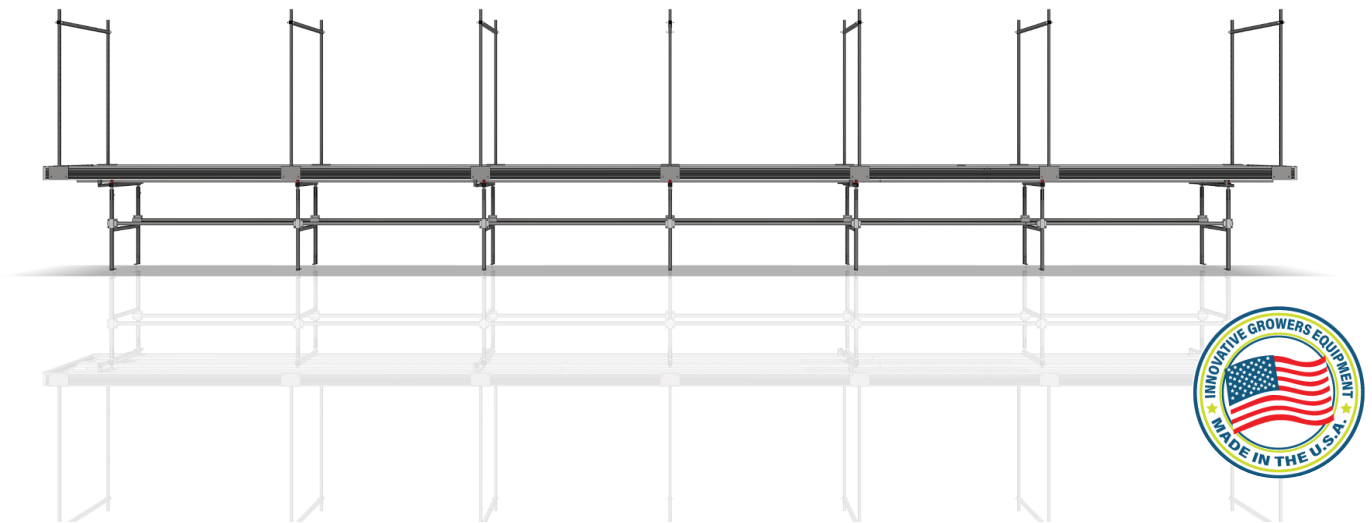

### TOOLS NEEDED FOR ASSEMBLY



TAPE MEASURE



DRILL W/ 5/16" HEX HEAD DRILL BIT



Call 815-991-5010 or email us at [support@innovativegrowersequipment.com](mailto:support@innovativegrowersequipment.com) if you have any questions

[INNOVATIVEGROWERSEQUPMENT.COM](http://INNOVATIVEGROWERSEQUPMENT.COM)

## PARTS LIST

CONFIRM ALL PARTS ARE PRESENT BEFORE STARTING INSTALLATION

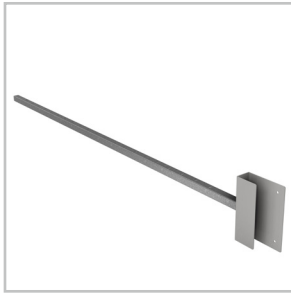

**PLANT SUPPORT  
UPRIGHT**



**PLANT SUPPORT  
CROSSBAR**

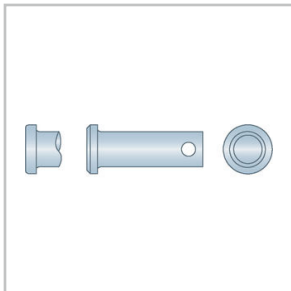

**CLEVIS PIN**

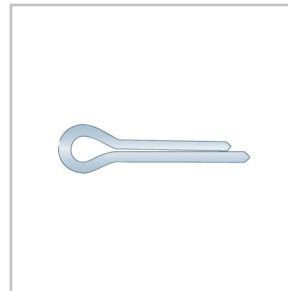

**COTTER PIN**



**TEK SCREWS (SELF  
TAPPING)**

## FOLLOW INSTRUCTIONS BELOW

### STEP #1

The Plant Support System will run the length of the bench. Take one Plant Support Upright and place it 2.0" from the end of the bench. Using two Tek Screws, secure the Plant Support Upright to the aluminum side rail of the bench. Do this on all four corners of the bench.

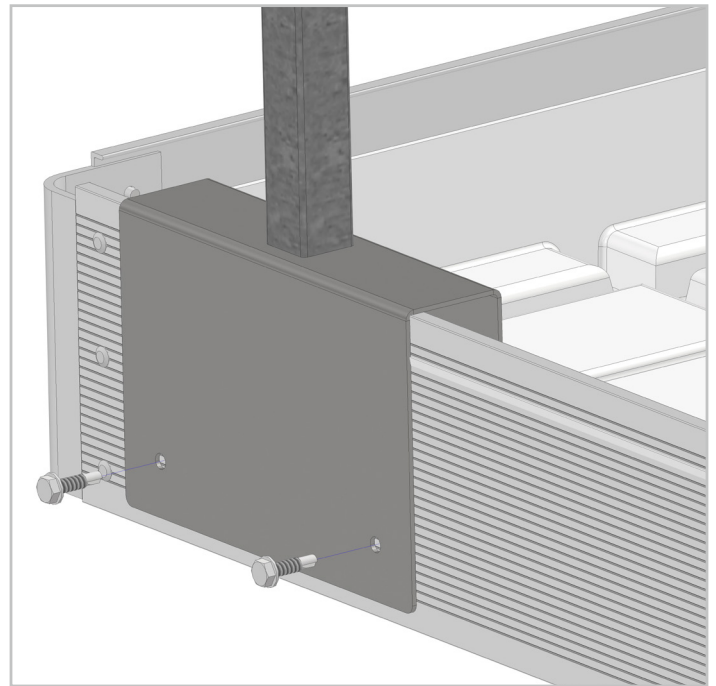

### STEP #2

The remaining Plant Support Uprights should be placed on center at each bench leg, on both sides of the bench.

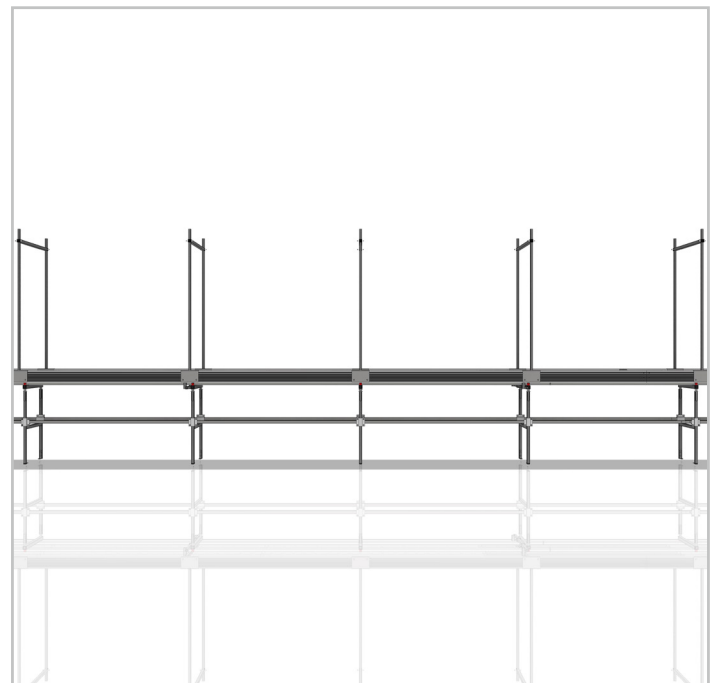

## FOLLOW INSTRUCTIONS BELOW (CONT.)

### STEP #3

Once all the Plant Support Uprights are secured to the bench, each pair of uprights will get its own Plant Support Crossbar. These are secured to the uprights by means of a Clevis Pin and a Cotter Pin.

*NOTE: Modify the crossbar height based on the height of the plant.*

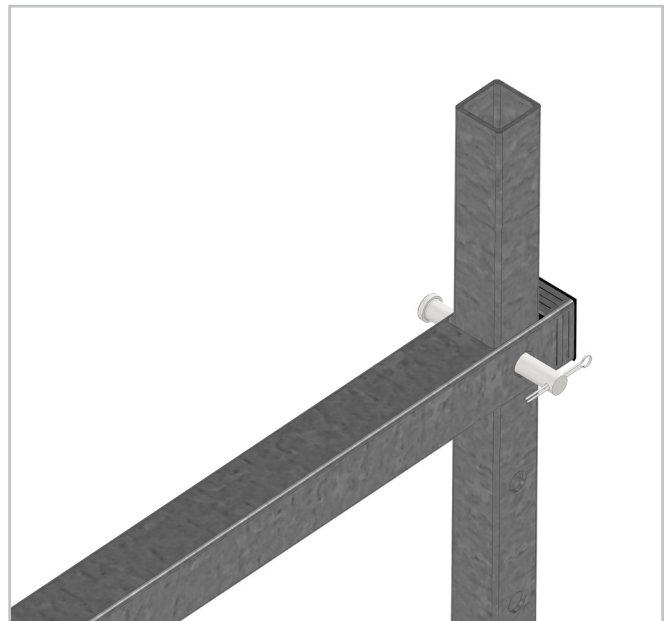
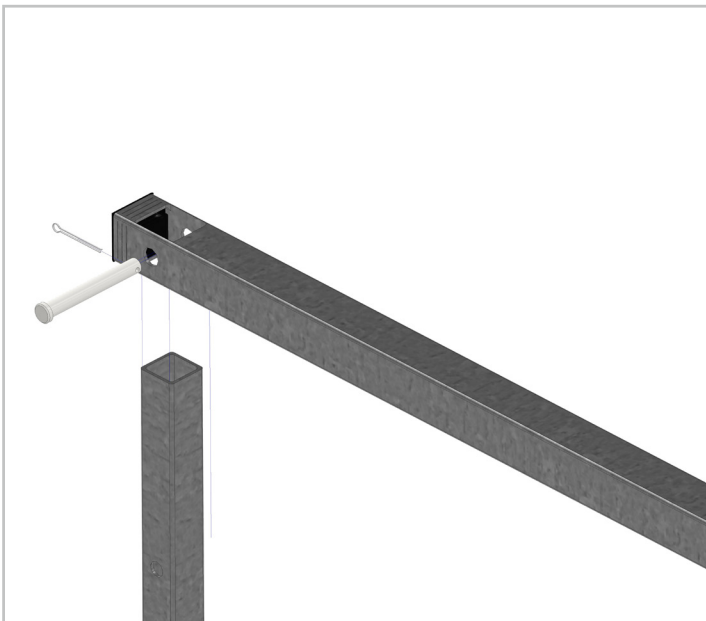



# CONGRATULATIONS YOUR PLANT SUPPORT SYSTEM IS COMPLETE!

